

BCK86

TMNT KFX

PW Advanced

|               |  |
|---------------|--|
| Age Range:    | 3 years and up                         |
| Weight Limit: | 65 lbs                                 |
| Surfaces:     | Monster Traction                       |
| Speed:        | 3 MPH Forward/Reverse<br>6 MPH Forward |
| Colors:       | Green and Blue w/Black Wheels          |
| Intro:        | 2014                                   |

Suggested Retail: \$245.00

Box Dimensions: 24.8" x 19.6" x 40.2"

Warranty: One Year Vehicle

Six Months Battery

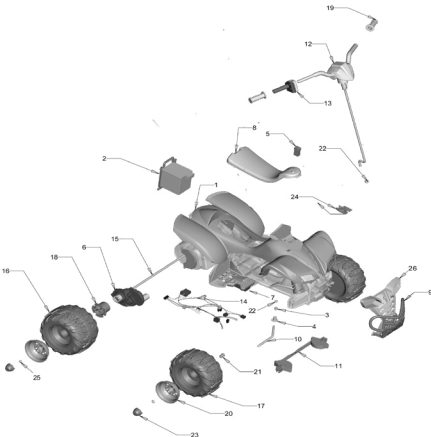

| Item | Part #                   | Description                            | QTY             |
|------|--------------------------|--|-----------------|
| 1    | N/A                      | Body                                   |                 |
| 2    | B9272-2419               | Battery Retainer for Kawasaki KFX      | 1               |
| 3    | J8472-2639               | Upper Bushing Kawasaki KFX             | 2               |
| 4    | J8472-2649               | Lower Bushing Kawasaki KFX             | 2               |
| 5    | 00801-1773               | Control Switch F/R - w/white buttons   | 1               |
| 6    | <b><u>00968-2951</u></b> | <b><u>Motor Gearbox Assembly*</u></b>  | <b><u>2</u></b> |
| 7    | BCK86-9060               | Footboard Assembly for KFX (purple)    | 1               |
| 8    | B9272-9169               | Seat for KFX                           | 1               |
| 9    | BCK86-2259               | Brush Guard for KFX                    | 1               |
| 10   | P5066-4519               | Front Axle (threaded) for KFX          | 2               |
| 11   | J8472-9060D              | Steering Linkage                       | 1               |
| 12   | W5540-9729               | Handlebar w/Steering Column & Harness  | 1               |
| 13   | P9723-9549               | Turbo Switch w/handle for Kawasaki KFX | 1               |
| 14   | <b><u>P5066-9799</u></b> | <b><u>Harness Assembly for KFX</u></b> | <b><u>1</u></b> |
| 15   | P5066-4509               | Rear Axle (threaded) for KFX           | 1               |
| 16   | B9272-2269               | Rear Wheel for KFX (black)             | 2               |
| 17   | B9272-2339               | Front Wheel for KFX (black)            | 2               |
| 18   | 74460-2249               | Wheel Driver 10 RIB                    | 2               |
| 19   | J5248-2439               | Handgrip for Brute Force               | 2               |
| 20   | W4715-6459               | Wheel Cover                            | 4               |
| 21   | 73610-2689               | Bushing .437 Long Black                | 2               |
| 22   | 00801-1621               | Cap (retainer .437) - Black            | 3               |
| 23   | W4715-6959               | Hubcap                                 | 4               |
| 24   | J8472-2859               | Steering Column Plate                  | 1               |
| 25   | 00905-0116               | 3/8" -16 Lock Nut                      | 4               |
| 26   | 3900-2522                | Front Clip for KFX                     | 1               |

## Part #

00801-1503

**00801-1520**

00801-1567

**00801-1678**

00801-1778

00801-1869

**00801-2039**

00912-8001

**00968-2729****00968-2821****74287-9739**

P5066-9289

BCK86-9200

BCK86-0720A

BCK86-0310A

**P5066-9659**

## Parts Not Shown

## Description

PW Emblem

**Switch Signalux - 2 prong**

Wrench 9/16" (Assembly Tool)

**Relay Switch**

12 Volt Charger w/Probe

12 Volt Battery (1)

**Footswitch - (plunger type)**

#8 x 3/4" screw (subs)

**Motor Pinion\*****# 7R Gearbox\*****PC Board\***

Hardware Bag for KFX

Parts Bag for KFX

Manual for KFX

Label Sheet for KFX

**Turbo Switch w/Wiring Harness for KFX\***

## QTY

1

1

1

1

1

1

1

4

2

2

1

1

1

1

1

\*When repairing parts for warranty, please refer to Additional Labor Rates under Reference Material on the B2B

**Bold and underlined parts are to be purchased and installed by Service Centers only. These items may not be sold directly to consumers by Service Centers or Fisher-Price.**